



**detroit
shoreway**

LAKE AVENUE

A THRIVING, VIBRANT, DIVERSE
AND WALKABLE NEIGHBORHOOD

PLANNING STUDY
COMMUNITY MEETING #2
05 29 2019

DETROIT SHOREWAY CDO
BIALOSKY CLEVELAND

AGENDA

1. Welcome

2. Project Update & Design Proposal

- Updates since last Steering Committee Meeting
- Public Engagement Feedback Review
- Typical Street Design Options
- W78th & Lake Ave Intersection Improvements
- W85th & Lake Ave Intersection Improvements
- Striebinger Bridge & Underpass to Clifton Blvd Intersection Improvements

3. Break Out & Discussion

4. Q+A & Next Steps





PROCESS

- ~~1. Steering Committee Meeting #1: Feb 13th~~
- ~~2. Public Meeting #1: Feb 20th~~
- ~~3. St. Luke's Community Dinner - March 13th~~
- ~~4. Steering Committee Meeting #2: March 20th~~
- ~~5. Steering Committee Meeting #3: May 23rd~~
- 6. Public Meeting #2: Wednesday, May 29th**
- 7. Ongoing Public Input through MindMixer*
- 8. Final report planning document: Summer 2019*
- 9. Present to Cleveland Planning Commission for Approval: Summer 2019*
- 10. Pursue Funding \$ for Implementation*

PROJECT GOALS

1. Improve safety for non-vehicular users along Lake Ave.
2. Identify opportunities for aesthetic improvements
3. Provide a community vision for equitable and inclusive future land-use & development
4. Re-envision the corridor's identity
5. Create a roadmap to pursue funding

MINDMIXER: *cleveland.mindmixer.com*



MindMixer





***PUBLIC ENGAGEMENT
FEEDBACK REVIEW***

STRENGTHS

(+)

51 TOTAL IDEAS &
COMMENTS

73 TOTAL IDEAS
& COMMENTS

(+)

OPPORTUNITIES

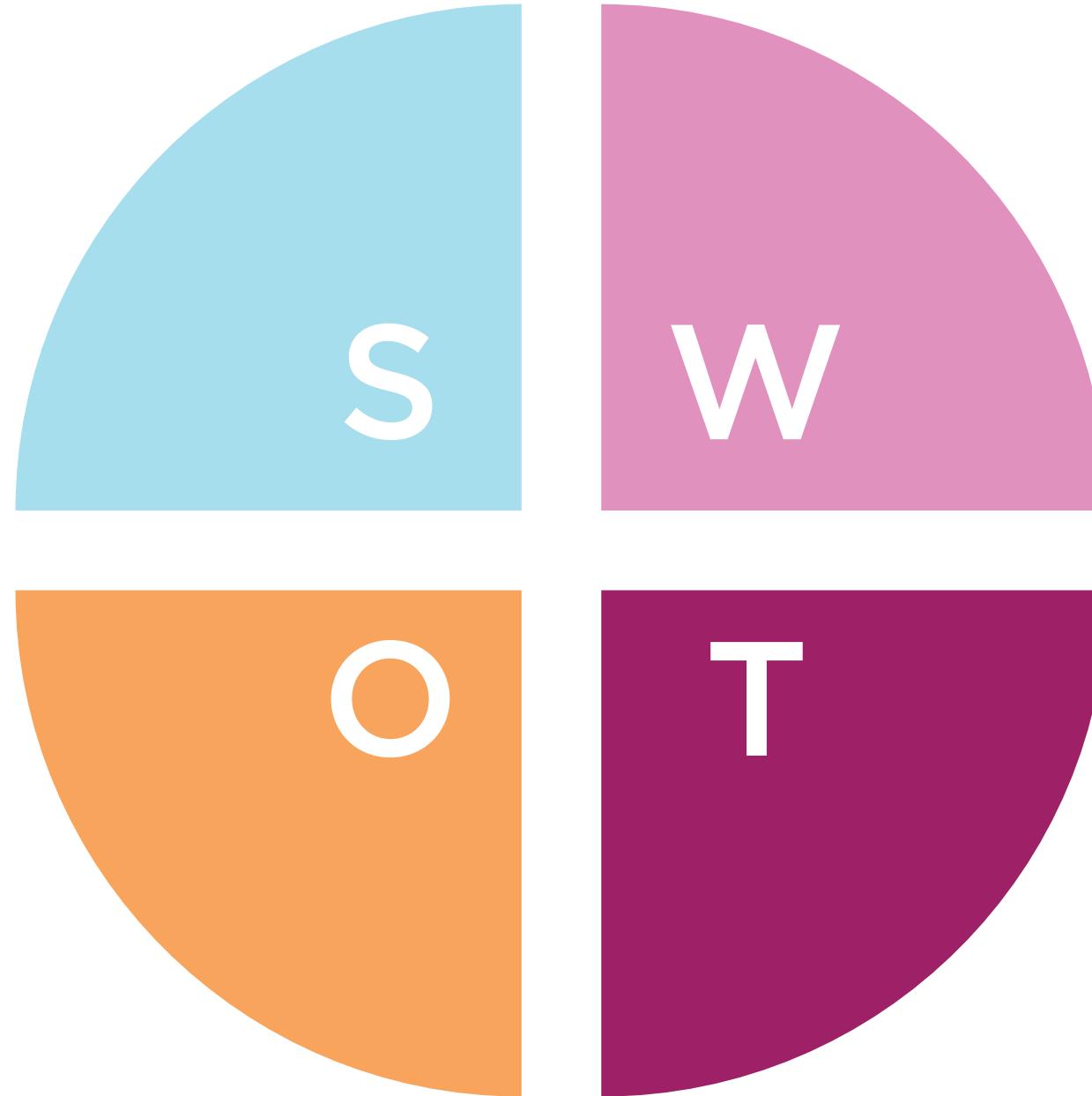

WEAKNESSES

(-)

66 TOTAL IDEAS &
COMMENTS

25 TOTAL IDEAS &
COMMENTS

(-)

THREATS

51 TOTAL IDEAS & COMMENTS

1. CONNECTIONS & GATEWAYS

20 IDEAS/COMMENTS

2. PHYSICAL ASSETS & AMENITIES

31 IDEAS/COMMENTS

SUMMARY- STRENGTHS

- CONNECTIONS, GATEWAYS, & ADJACENCIES
- WALKABILITY & PUBLIC TRANSIT
- DIVERSITY & AFFORDABILITY
- ESTABLISHED ANCHORS
 - CPL-WALZ BRANCH
 - WEST 78TH STREET STUDIOS
 - ST. LUKE'S EPISCOPAL CHURCH
- STRONG NEIGHBORHOOD HISTORY



66 TOTAL IDEAS & COMMENTS

I. SAFETY

22 IDEAS/COMMENTS

2. PHYSICAL ASSETS & AMENITIES

31 IDEAS/COMMENTS

3. LIVABILITY, IDENTITY, & WAYFINDING

13 IDEAS/COMMENTS

SUMMARY- WEAKNESSES

- SAFETY & LIGHTING
 - HEAVY TRAFFIC
- POOR CONDITIONS OF PEDESTRIAN INFRASTRUCTURE
 - ROADS & SIDEWALKS ARE IN DISREPAIR
- LACK OF ATTRACTIVE AESTHETICS (TREE LAWNS, ETC.)
 - N/S BRIDGE IS IN GENERAL STATE OF REPAIR
 - WATER AND DRAINAGE ISSUES
 - GENERAL LACK OF IDENTITY
- NO WAYFINDING TO ASSETS (LAKE PARK, WEST 78TH ST. STUDIOS, EDGEWATER PARK)



T

25 TOTAL IDEAS & COMMENTS

SAFETY

19 IDEAS/COMMENTS

PHYSICAL ASSETS & AMENITIES

6 IDEAS/COMMENTS

SUMMARY- THREATS

- CRIME & SAFETY
- SPEED OF TRAFFIC
- DANGEROUS INTERSECTIONS
- GENTRIFICATION & DISPLACEMENT

73 TOTAL IDEAS & COMMENTS

STREETSCAPE IMPROVEMENTS

46 IDEAS/COMMENTS

WAYFINDING & IDENTITY

8 IDEAS/COMMENTS

REAL ESTATE DEVELOPMENT

10 IDEAS/COMMENTS

SAFETY

9 IDEAS/COMMENTS

SUMMARY- OPPORTUNITIES

•STREETSCAPE IMPROVEMENTS:

- BIKE LANES
- MORE TREE LAWNS
- PUBLIC ART DISPLAYS
- DOG PARK
- PEDESTRIAN CROSSINGS
- STREET FURNISHINGS

•WAYFINDING & SIGNAGE IMPROVEMENTS

•REAL ESTATE DEVELOPMENT:

- AFFORDABLE & EQUITABLE HOUSING
- LOCALLY OWNED & NEIGHBORHOOD-FOCUSED RETAIL
- IMPROVED & EXPANDED GREEN SPACE



PROPOSED IMPROVEMENTS

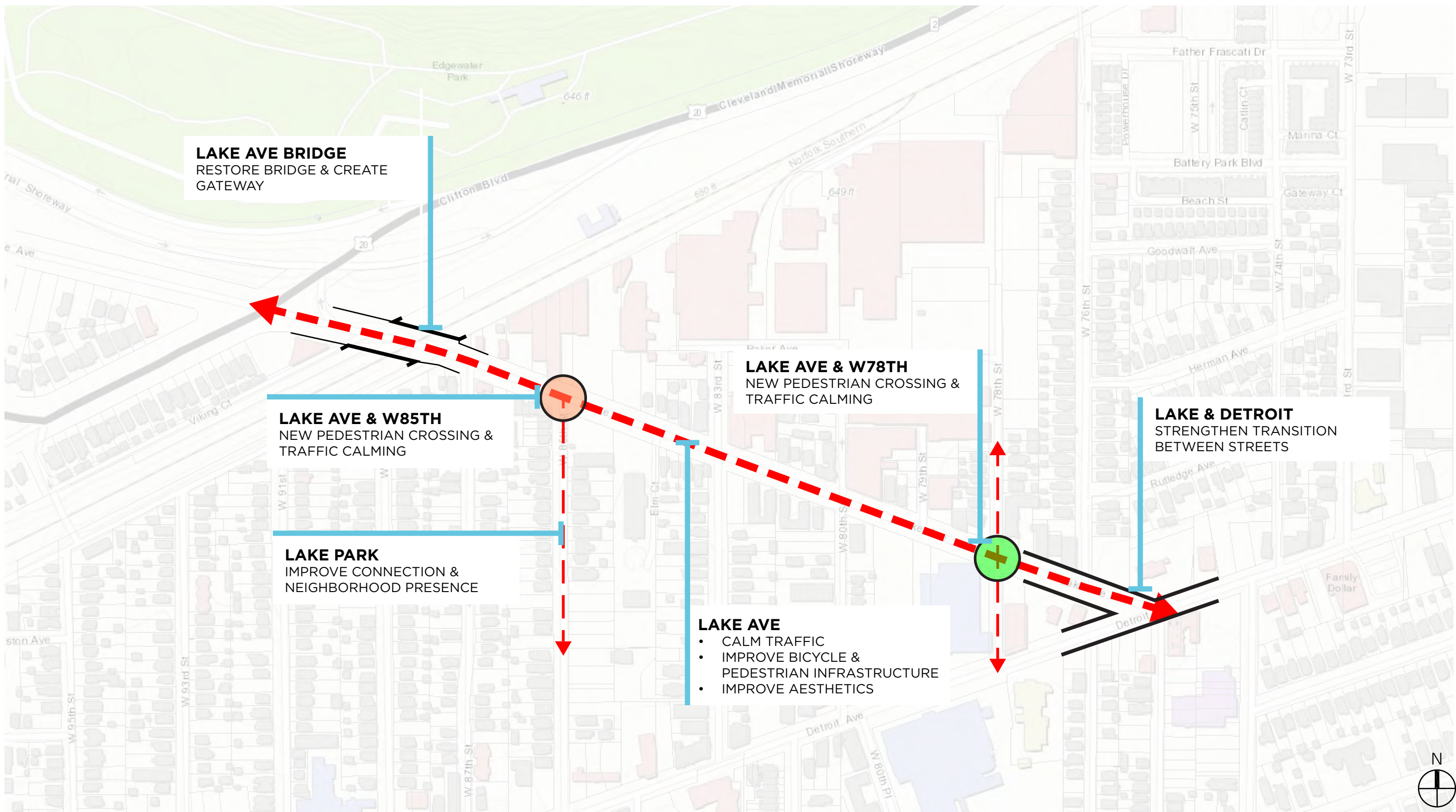

An aerial, black and white photograph of a city street, likely Lake Ave in Cleveland. The street runs vertically through the center of the image. On the left side, there are several multi-story buildings, including a large one with many windows. A sign for 'EXPRESS GAS' is visible on a building. On the right side, there are smaller buildings, including a 'BURGER KING' restaurant with its sign clearly visible. A sign for 'ARMSTRONG'S LAUNDRY' is also visible. The street is lined with trees and parked cars. The overall scene depicts a typical urban neighborhood.

TYPICAL LAKE AVE LOCATIONS: PROPOSED IMPROVEMENTS

EXISTING STREET

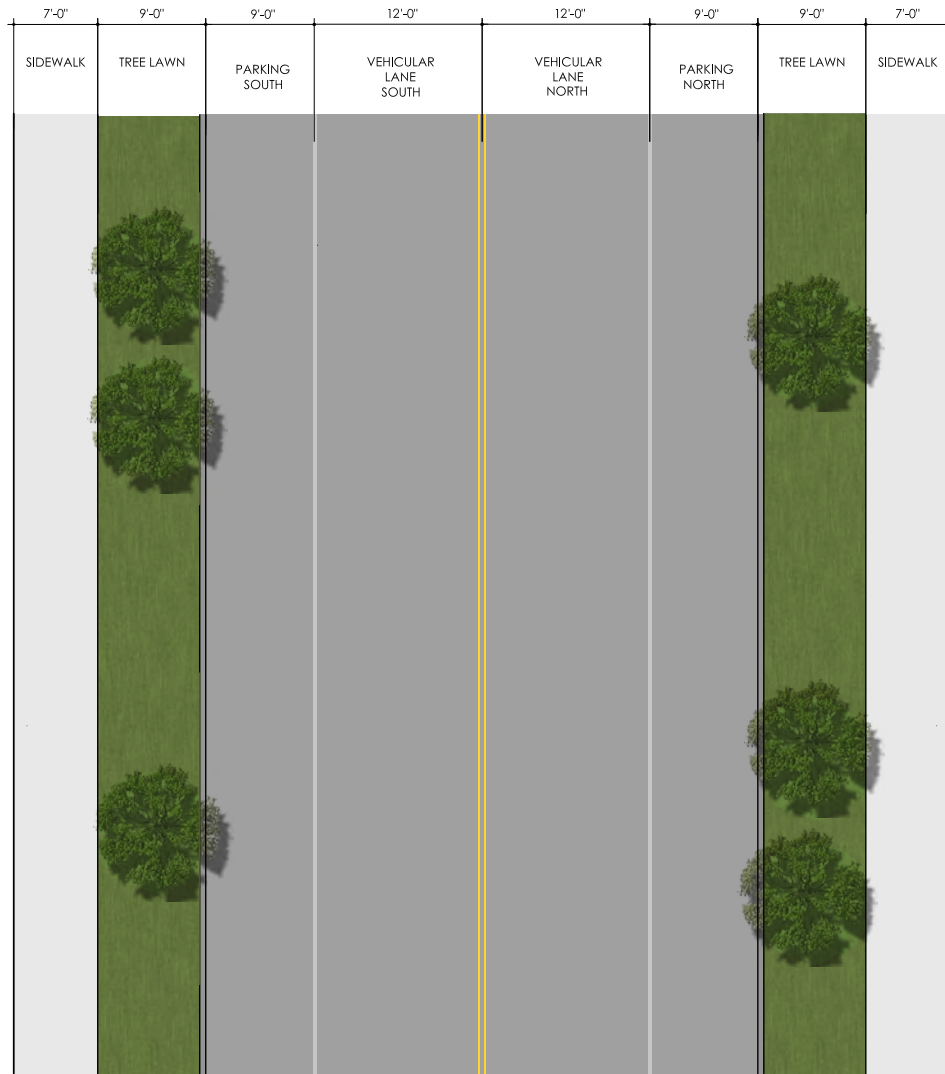

PREFERRED OPTION

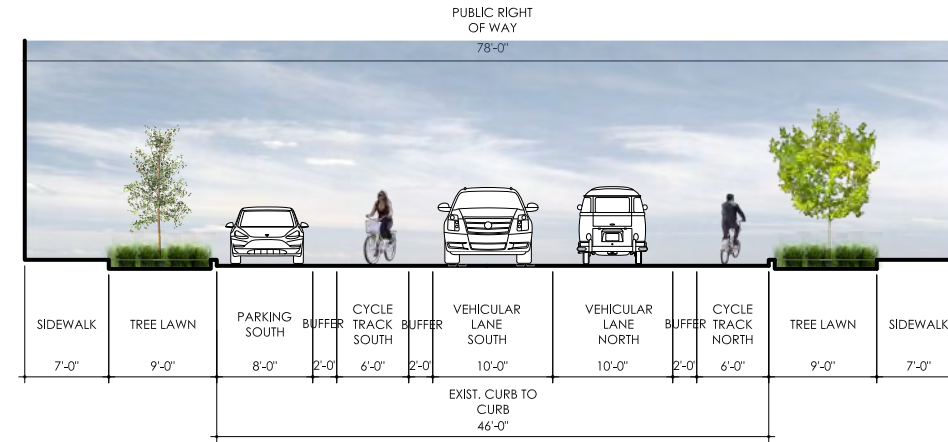
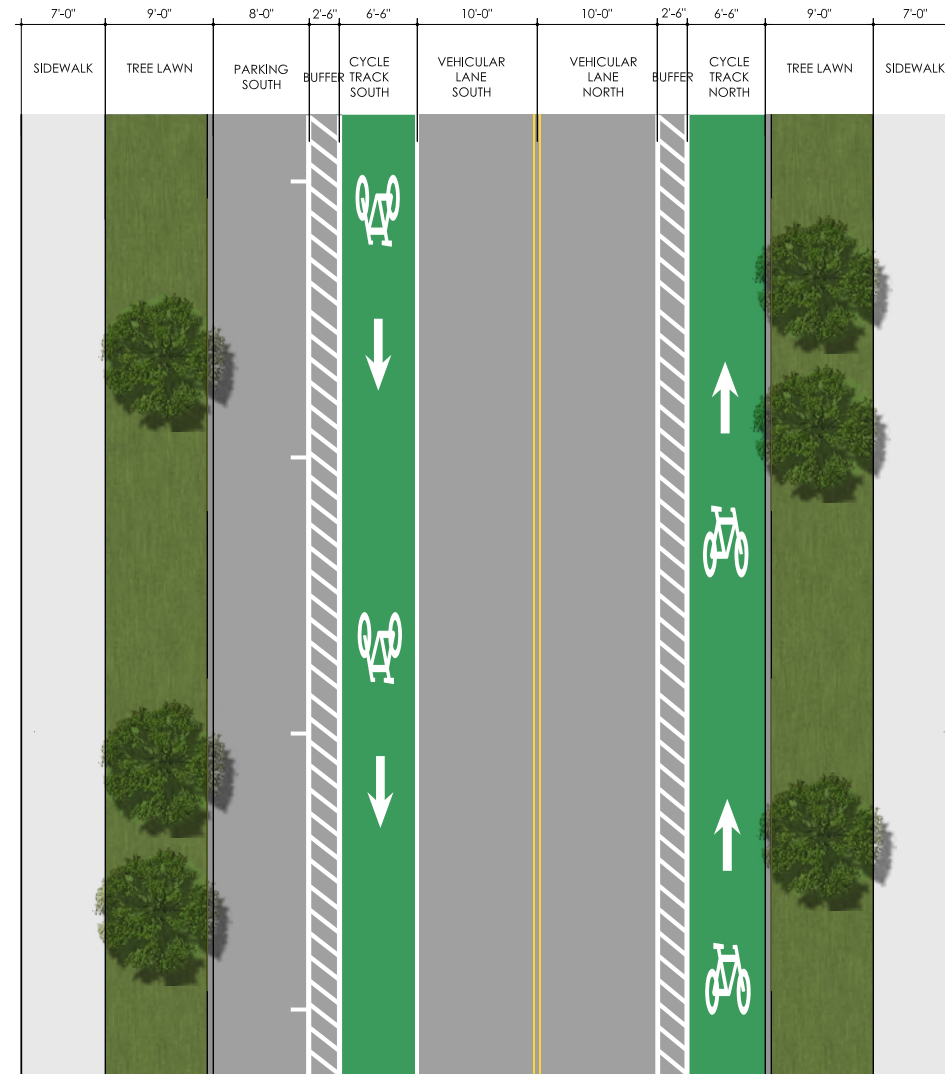

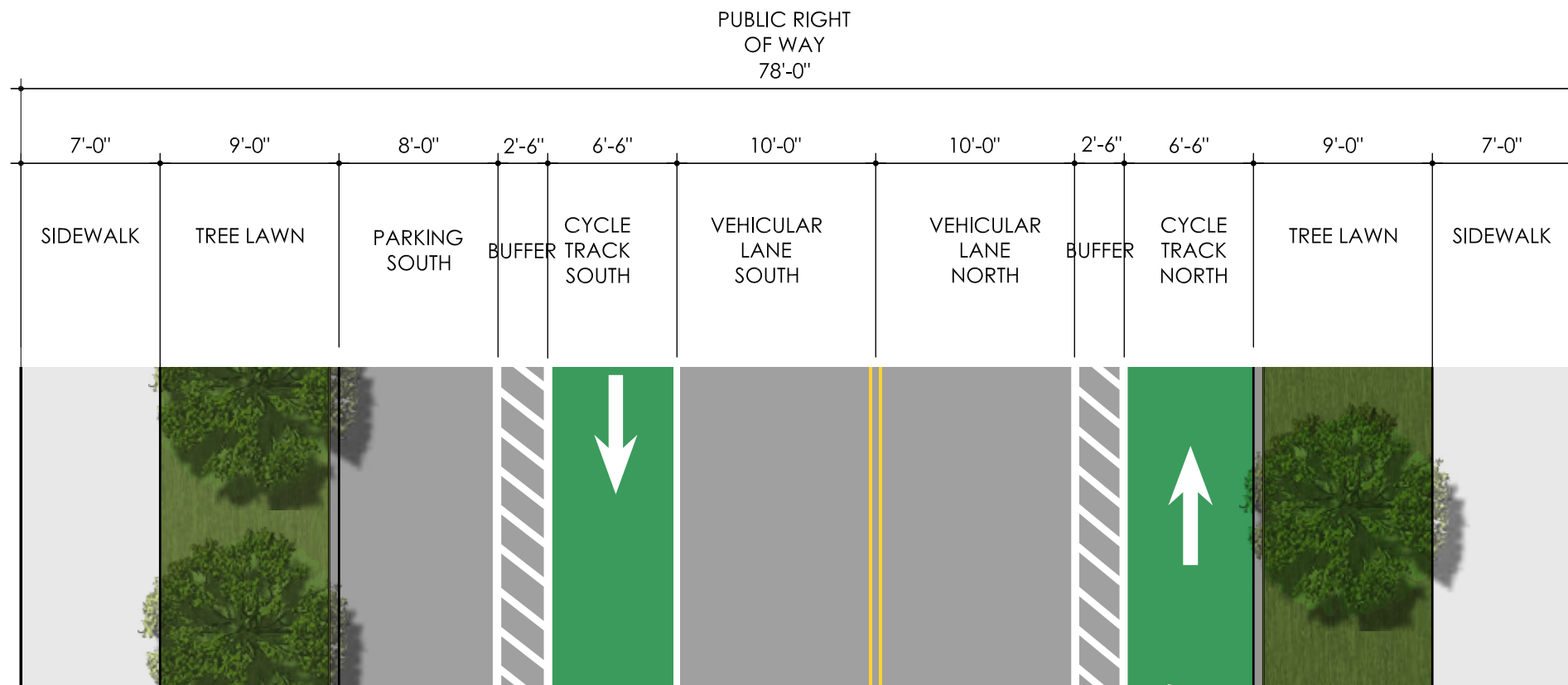

PROS & CONS

PROS

- 10'-0" WIDE LANES ARE MOST EFFECTIVE AT CALMING TRAFFIC
- BIKE LANES & BUFFERS MEET CITY DESIGN STANDARDS
- DESIGN HAS INFORMAL APPROVAL BY CITY ENGINEERING

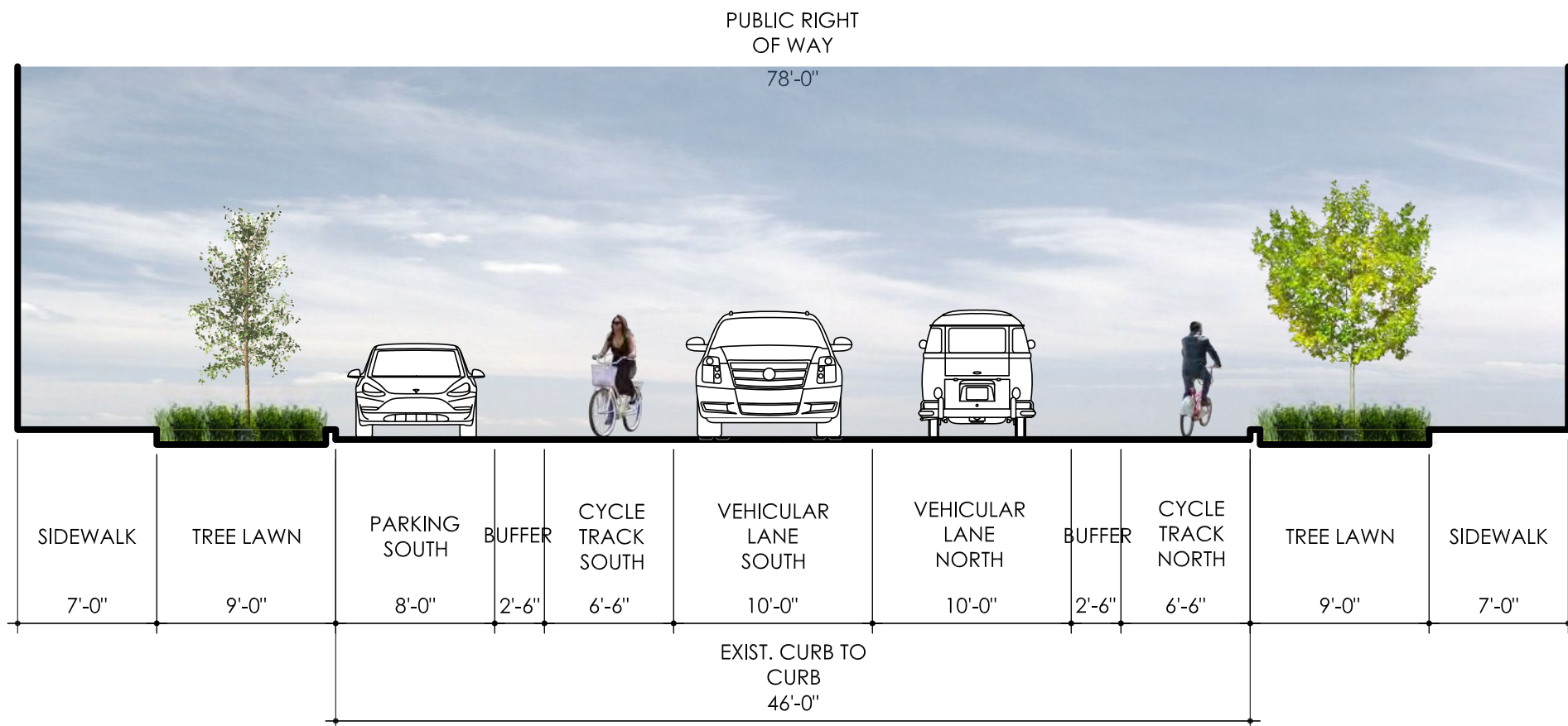

CONS

- NO BUFFER BETWEEN BIKE AND TRAFFIC LANES ON SOUTH SIDE OF STREET (EAST BOUND)



LAKE & W 78TH INTERSECTION



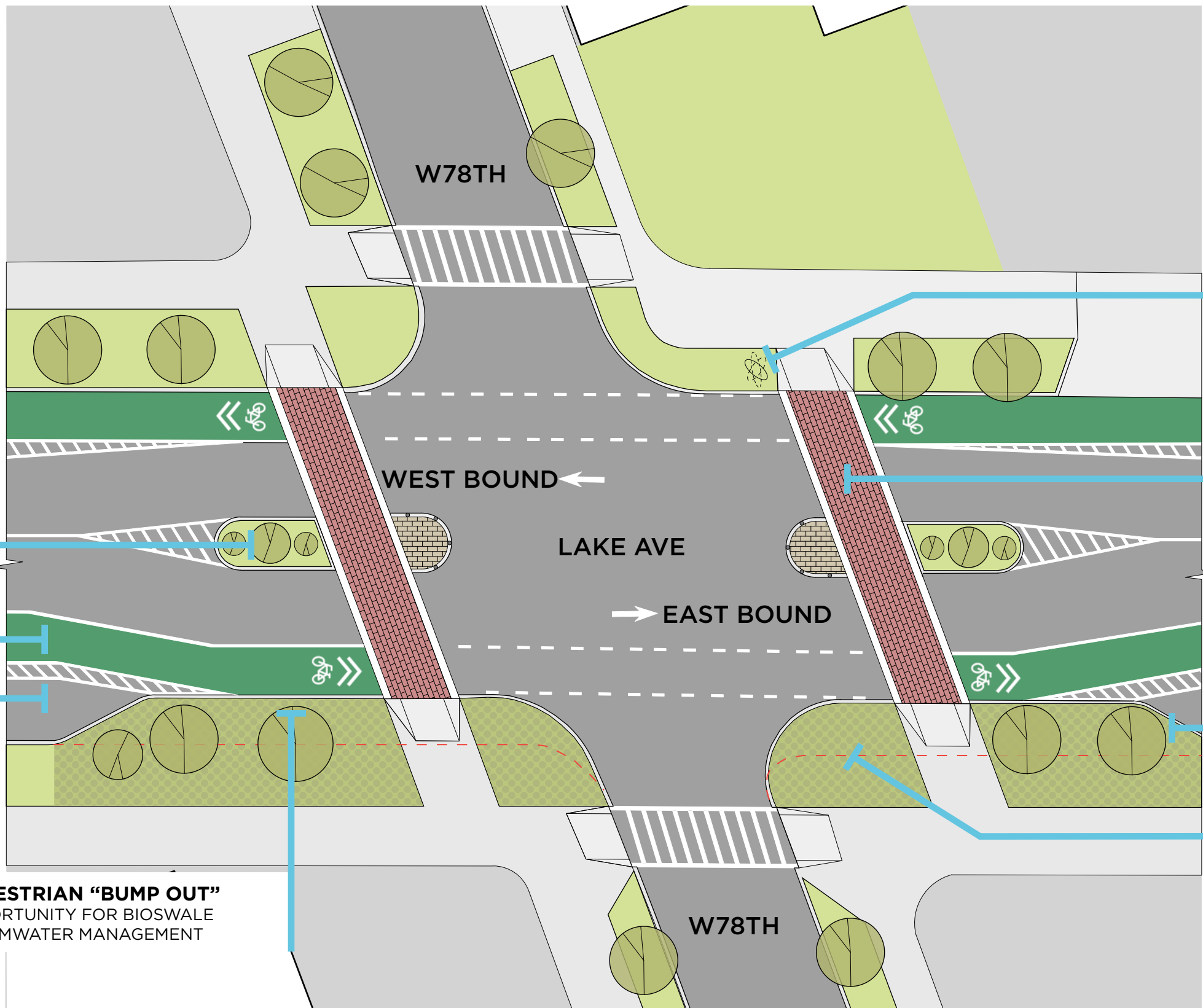

GSAD STREETSCAPE PUBLIC ART TO REMAIN

DECORATIVE CROSSWALKS
SIMILAR TO DETROIT AVE & WEST SHOREWAY CROSSWALKS

PEDESTRIAN "BUMP OUT"
OPPORTUNITY FOR BIOSWALE STORMWATER MANAGEMENT

EXISTING CURB CUT

PEDESTRIAN REFUGE ISLAND
• INCREASES SAFETY & CALMS TRAFFIC
• OPPORTUNITIES FOR LANDSCAPING & WAYFINDING

BIKE LANES
PAINTED GREEN FOR BETTER USER SAFETY

STREET PARKING
BUFFERED FROM BIKE LANES

PEDESTRIAN "BUMP OUT"
OPPORTUNITY FOR BIOSWALE STORMWATER MANAGEMENT

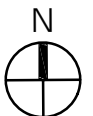







LAKE & W85TH INTERSECTION

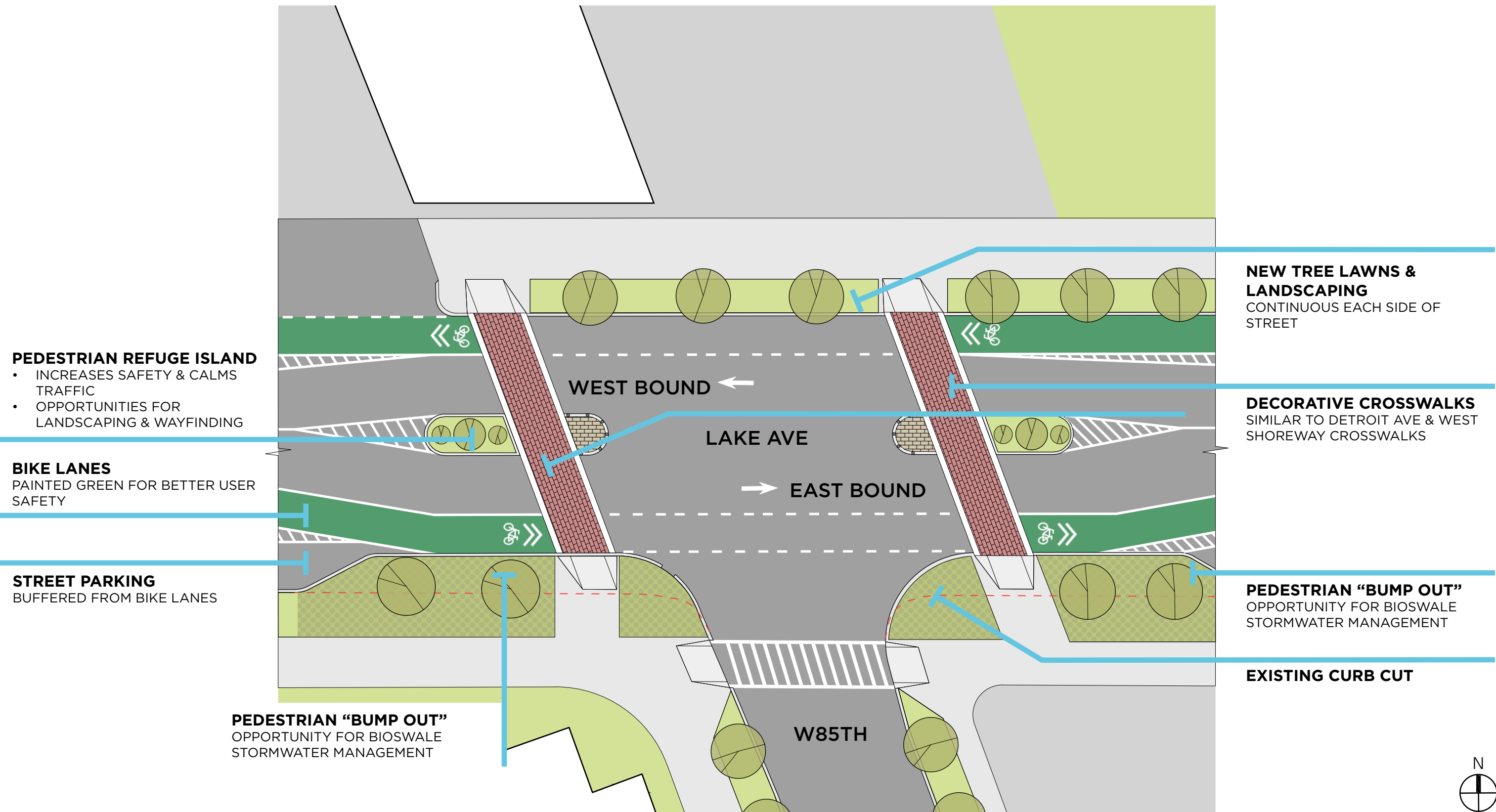

PEDESTRIAN REFUGE ISLAND

- INCREASES SAFETY & CALMS TRAFFIC
- OPPORTUNITIES FOR LANDSCAPING & WAYFINDING

BIKE LANES

PAINTED GREEN FOR BETTER USER SAFETY

STREET PARKING

BUFFERED FROM BIKE LANES

PEDESTRIAN "BUMP OUT"

OPPORTUNITY FOR BIOSWALE STORMWATER MANAGEMENT

NEW TREE LAWNS & LANDSCAPING

CONTINUOUS EACH SIDE OF STREET

DECORATIVE CROSSWALKS

SIMILAR TO DETROIT AVE & WEST SHOREWAY CROSSWALKS

PEDESTRIAN "BUMP OUT"

OPPORTUNITY FOR BIOSWALE STORMWATER MANAGEMENT

EXISTING CURB CUT



THE STRIEBINGER BRIDGE TO CLIFTON BLVD



BRIDGE TOO PLAIN, PLAN IS REJECTED

Drawing of Proposed Structure at Lake-av Does Not Meet With Approval.

Lake Shore to Help Carry Out 'City Beautiful' Policy.

Declaring that plans for too plain a structure had been submitted by the Lake Shore railroad, city officials have decided not accept the first drawing for the proposed new grade crossing bridge at the Lake-av entrance to Edgewater park. To assist the city in following the "city beautiful" policy in the new grade crossing work at this point P. W. Striebinger has been retained as consulting architect.

The project was discussed at a meeting in the office of City Engineer Hoffman yesterday attended by representatives of the Lake Shore railroad and by Architect Striebinger. The latter was instructed by the city to prepare a drawing showing the changes in the Lake Shore's plans that were suggested after their submission.

"We believe that the changes will

HISTORIC BRIDGES

Lake Avenue Railroad Overpass

Rating [National 9 Local 9]

Railroad (Amtrak) Over Lake Avenue in Cleveland: Cuyahoga County, Ohio, United States

Metal Deck Girder, Fixed

This bridge has a unique cast iron encasement that makes it one of the most beautiful existing examples of cast iron ornamentation on a bridge.

Lorain-Carnegie Bridge

Hope Memorial Bridge

Rating [National 8 Local 9]

Lorain Avenue and Carnegie Avenue (OH-10) Over Cuyahoga River in Cleveland: Cuyahoga County, Ohio, United States

Metal Cantilever 12 Panel Rivet-Connected Pratt Deck Truss, Fixed and Approach Spans: Metal Stringer (Multi-Beam), Fixed

This stunning bridge is a beautiful union of aesthetic superstructure and artistic embellishments.

Detroit-Superior Bridge

Veterans Memorial Bridge

Rating [National 8 Local 9]

Detroit and Superior Avenues (US-6) Over Cuyahoga River in Cleveland: Cuyahoga County, Ohio, United States

Metal Braced Ribbed Through Arch, Fixed and Approach Spans: Concrete Open Spandrel Deck Arch, Fixed

This awe-inspiring structure is among the most well-known of Cleveland's landmarks.

*ALL DATA WAS COLLECTED BY HISTORICBRIDGES.ORG

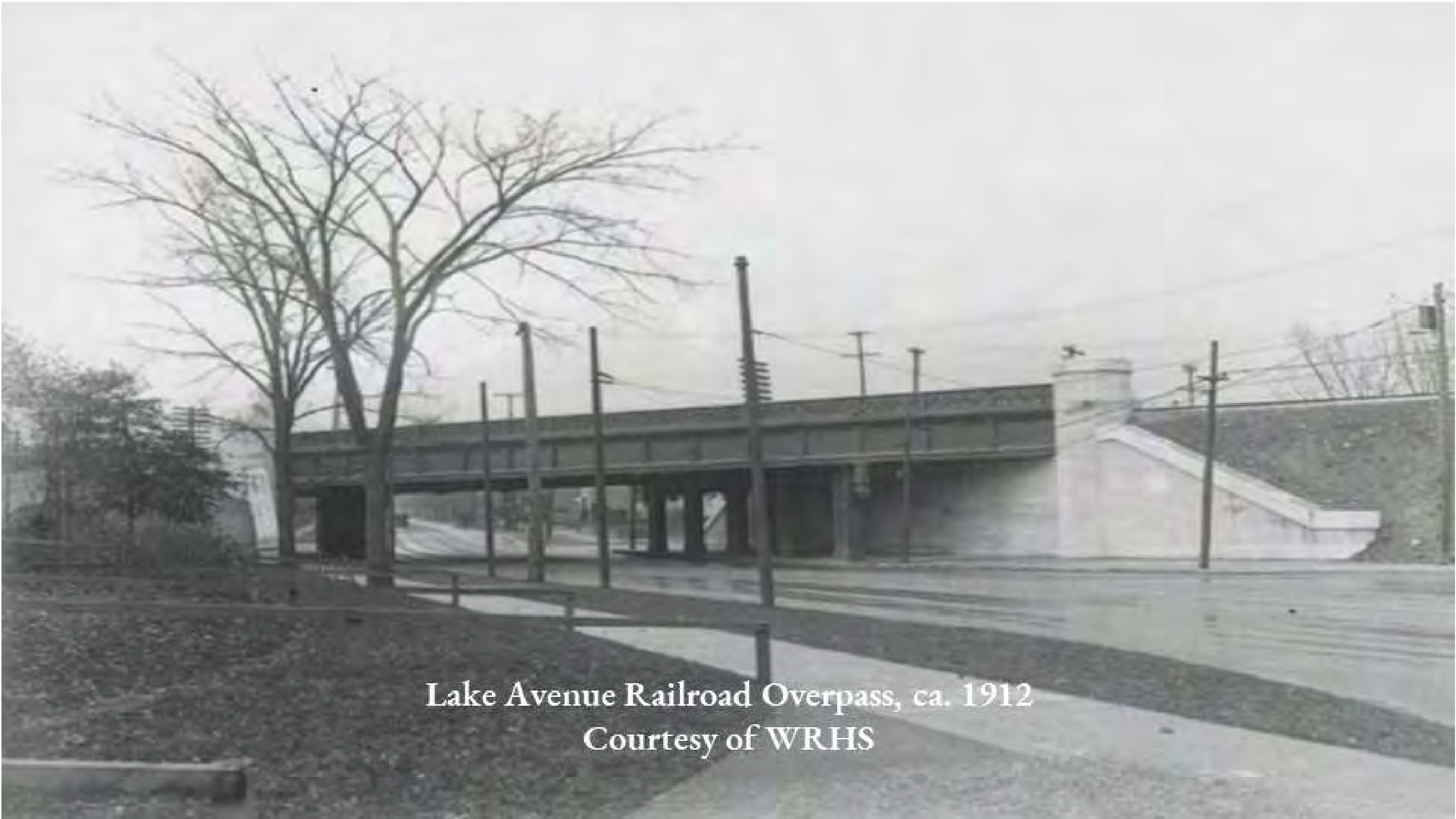

Lake Avenue Railroad Overpass, ca. 1912
Courtesy of WRHS







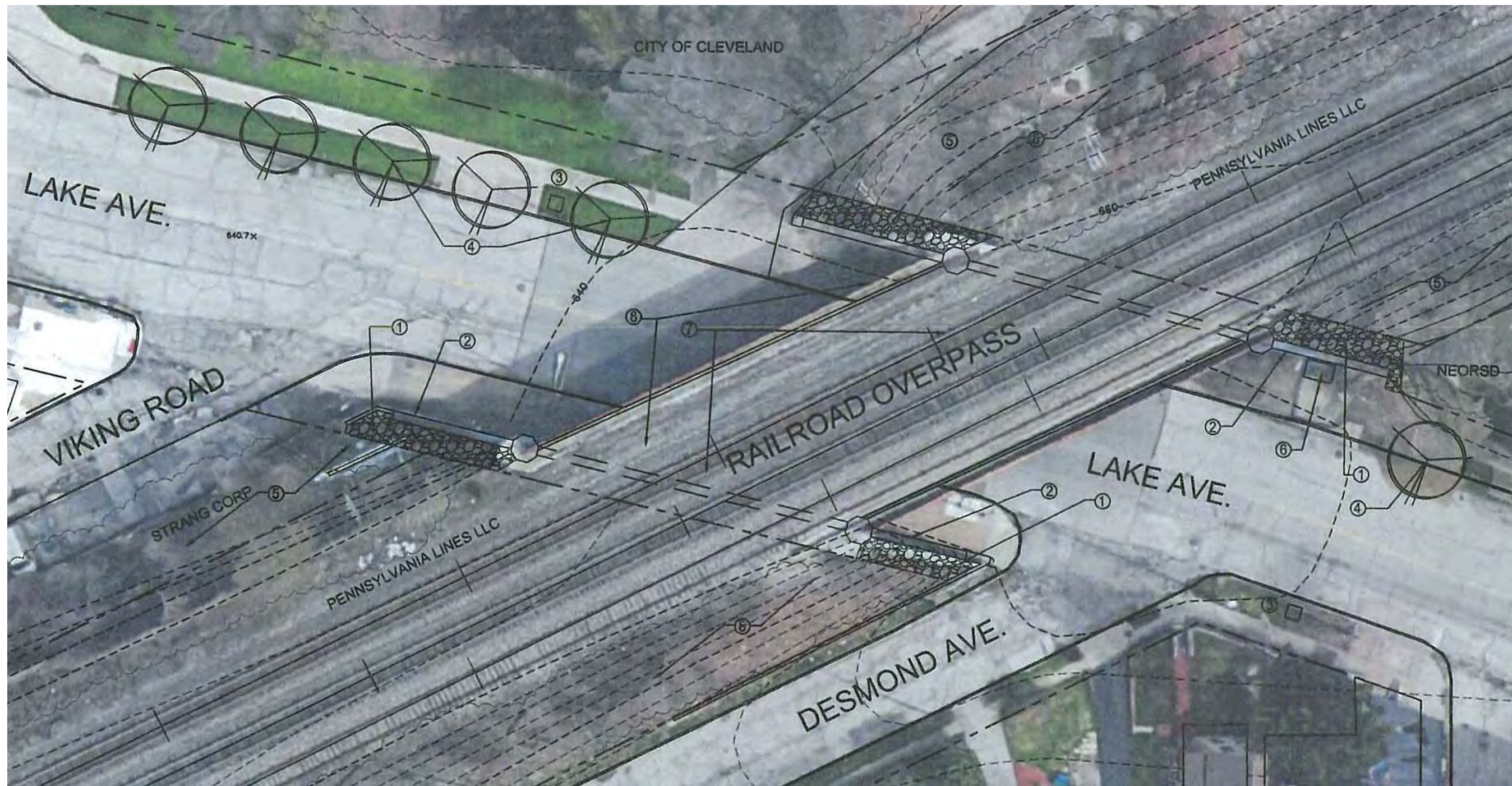

CONCEPT FOR PROPOSED IMPROVEMENTS:

IMPLEMENT SITE IMPROVEMENTS AND RESTORE STANDARDS THAT ARE CONSISTENT WITH NEARBY NEIGHBORHOOD TRANSITIONS:

- SAFETY
- BEAUTIFICATION
- NEIGHBORHOOD IDENTITY

PROPOSED ACTION ITEMS:

- ① Remove vegetation and rubble from hillsides. Backfill excavated areas behind abutments with glaciated boulders and topsoil for pockets of native grasses and perennials.
- ② Patch and paint concrete bridge abutments.
- ③ Add feature/signage to provide identities of Edgewater and Gordon Square communities respective sides of overpass.

- ④ Add street trees along north side of Lake Ave.
- ⑤ With private funding & community action, extend hillside site improvements beyond right-of-way areas.
- ⑥ Remove abandoned structure.
- ⑦ Add lighting under overpass per Engineering & Construction.
- ⑧ Replace damaged sidewalk under overpass per Engineering & Construction.

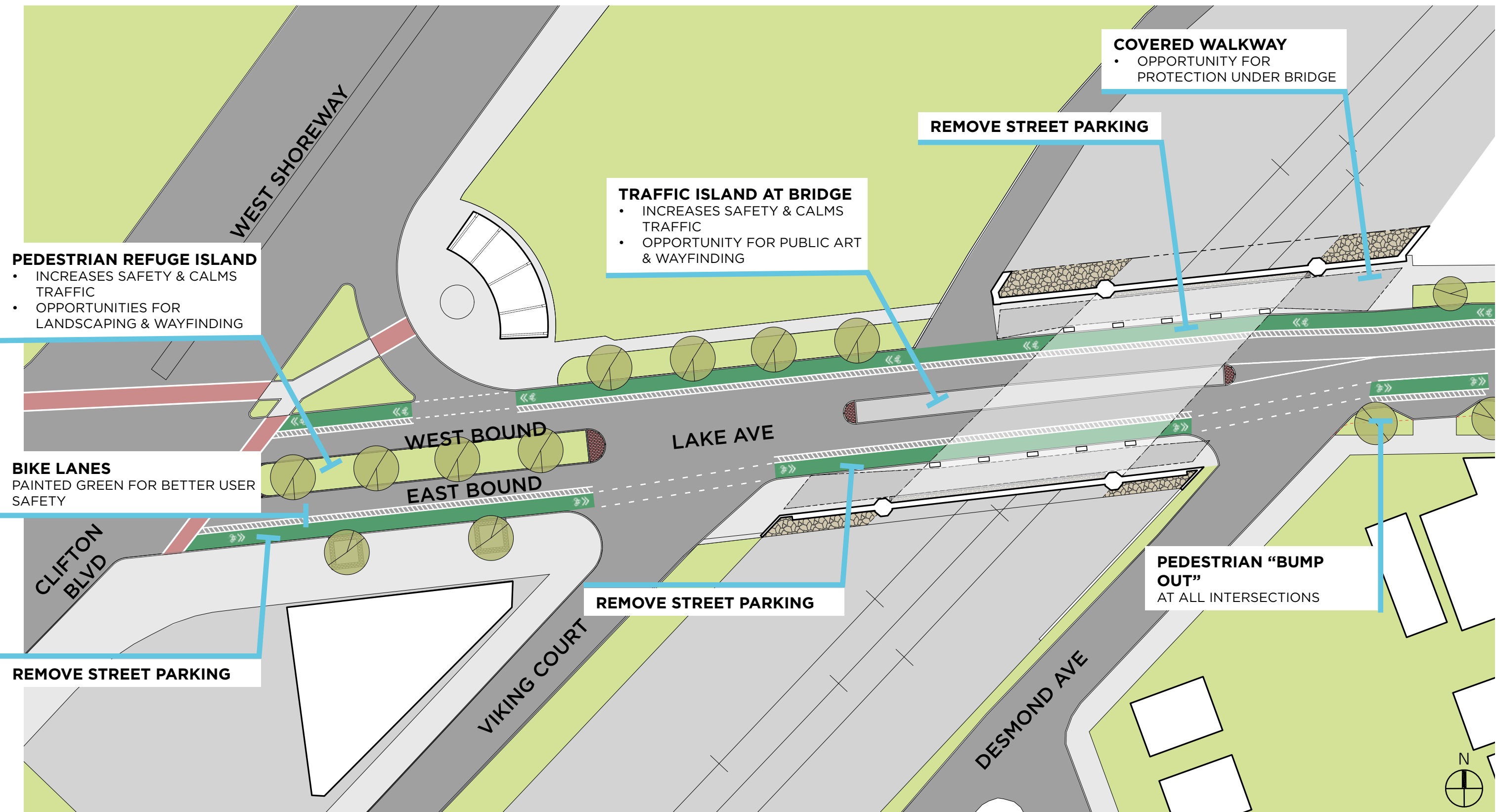









BREAKOUT STATIONS

1 CROSS WALKS

Facilitators:

- Nikki Hudson
(Lake Ave Steering Committee)
- Adam Davenport
(City of Cleveland Planning)



2 STRIEBINGER BRIDGE

Facilitators:

- Morgan Taggart
(Lake Ave Steering Committee)
- Emily Williams
(Bialosky)



3 PUBLIC ART & SIGNAGE

Facilitators:

- Michael Armstrong
(Lake Ave Steering Committee)
- Julia Van Wagenen
(Lake Ave Steering Committee)

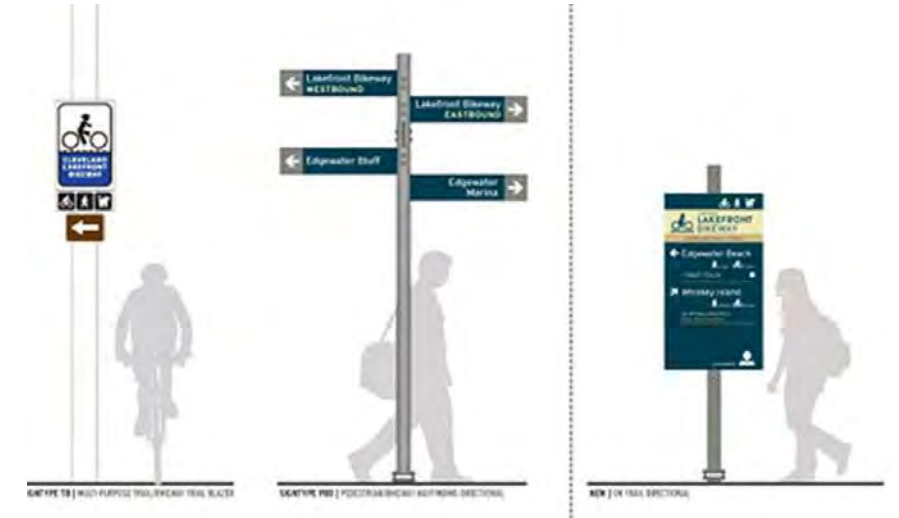



OPEN FEEDBACK + Q&A