

# ALTERNATIVE 3 | NARRATIVE

Plan Alternative Three takes a more traditional approach to the development of the site, while maintaining features brought forth at the workshop. Two areas of residential development are proposed; condominiums for sale on the north end of the site with small lot detached alley homes arcing to the south. The multi-family site includes an overlook area adjacent to the loop bicycle/pedestrian trail. Open space areas include an interface to the surrounding Bureau of Land Management lands to the north, retention of onsite open space features, and a buffer to the existing residents to the south. Parks remain a prominent feature of the plan. The largest park to the southwest features a relocated trailhead to the bike trail, parking and a community barn/pavilion that can act as a destination for events. The elevated area of the site in the southeast corner becomes home to a historic interpretive kiosk and the jumping-off point for a walking loop that feature multiple stations telling the story of the land and Folsom's past. Parking is provided on-site to encourage visitors to park outside of the existing neighborhoods.

Vehicular circulation is proposed to continue Leidesdorff Street along the front of the approved Leidesdorff Village and connect directly to Forrest Street. An enhanced intersection or roundabout is proposed leading to a short northerly street that terminates in the small neighborhood park and branches east and west to proposed development. A second connection to the bike trail is proposed along the north edge of the site. A network of internal bicycle/pedestrian trails interlinks the site with both on-street and off-street facilities. Additional parking is proposed throughout the plan and adjacent to the Folsom Veterans Hall.

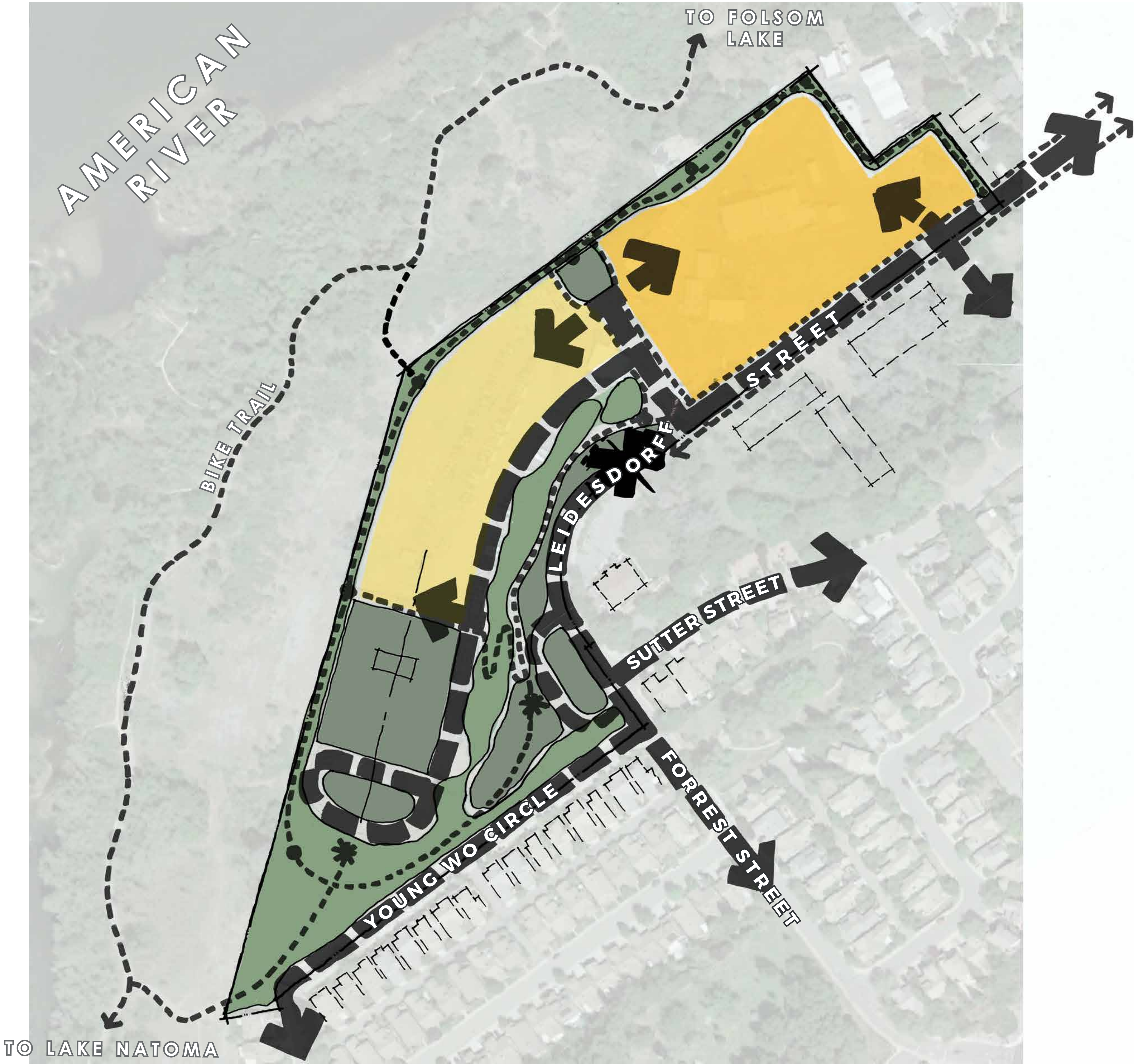









# ALTERNATIVE 3 | DRAFT MASTER PLAN

- 1 TO HISTORIC FOLSOM
- 2 TO EXISTING NEIGHBORHOOD
- 3 APPROVED LEIDESDORFF VILLAGE
- 4 FOLSOM VETERANS HALL
- 5 PARKING
- 6 CONTROLLED OR MITIGATED ACCESS (EMERGENCY VEHICLE ACCESS, GATED, PERMIT PARKING)
- 7 RELOCATED TRAILHEAD
- 8 HISTORIC WALK TRAILHEAD (INFORMATIONAL KIOSK WITH WALKING LOOP & HISTORIC INFORMATION STATIONS)
- 9 PROPOSED BIKE TRAIL CONNECTION
- 10 OPEN SPACE
- 11 PARK WITH INTERPRETIVE HISTORY DISPLAY & OVERLOOK
- 12 PARK WITH PAVILION / COMMUNITY BARN / EVENT SPACE
- 13 BIKE TRAIL TRAILHEAD MINI PARK
- 14 HISTORY WALK PARK

**LEGEND:**

-  VEHICULAR CIRCULATION
-  BICYCLE / PEDESTRIAN CONNECTION
-  OPEN SPACE
-  PARKS
-  RESIDENTIAL ATTACHED FOR SALE TOWNHOMES OR CONDOMINIUMS
-  RESIDENTIAL DETACHED FOR SALE ALLEY HOMES

