

# Civic Art

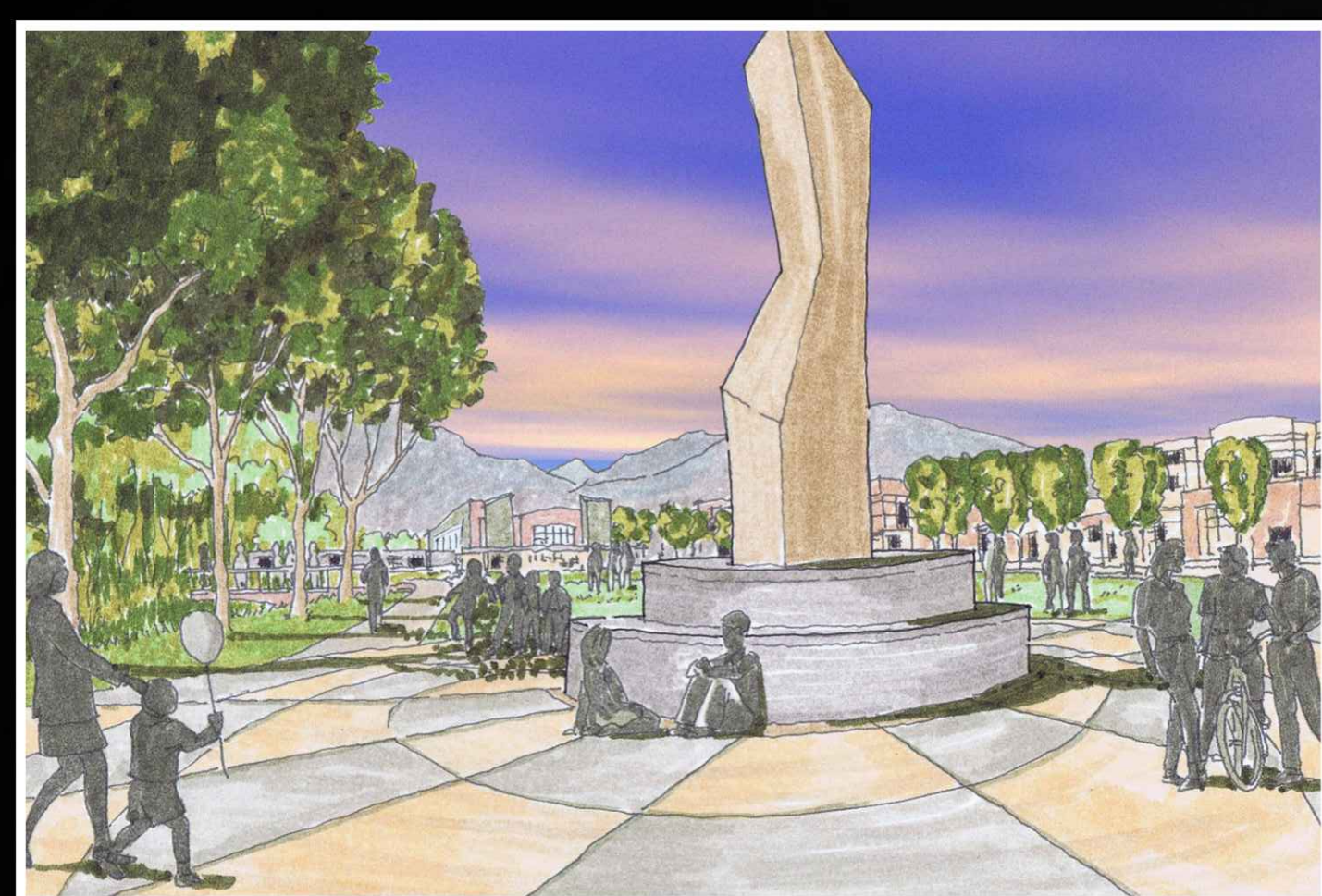

**CIVIC ART** re-visions the transformative work created during Frederick Law Olmsted's infatuation with Boulder. Through his extensive appraisals, the many epoch periods and transects that have shaped our city were formalized and an appreciation towards "place-making" was indelibly burned into our community's spirit. **CIVIC ART's** proposals bolster our **Civic Heart** and ensure that remains a "place for everyone—a lively and distinct destination that reflects our community's values, where people of all ages, abilities and backgrounds feel welcome to recreate, socialize, deliberate, learn and access city services" and the arts.

"To aim for order and hope for beauty" - Frederick Law Olmsted Jr.



Located on the vacated site of the New Britain and Park Central buildings, the Gilbert F. White kiosk honors his dream of seeing city office structures removed from the Boulder Creek High Hazard Zone. The kiosk will educate the public and Civic Area and building users about safety and risks associated with flooding and natural and public values of water.



For nearly half a century, a Performing Arts Center has been envisioned in the downtown area. This state-of-the-art facility will anchor the eastern end of the Civic Center and be available and affordable for use by local performing arts organizations, as well as provide a variety of programs that will entertain and enlighten a wide variety of audiences.



The E. Robert Turner Service Center is architecturally evocative of Boulder's powerful geological forces while also demonstrating and showcasing Boulder's commitment to Energy Efficiency and Renewable Energy technologies. The facility will provide a centralized service center that replaces the Park Central and New Britain buildings which will remove those city staff and building users from the Boulder Creek High Hazard zone. Anchoring the "Spoke of the Wheel" plaza at 9th and Canyon, the structure's south facing atrium - comprised of a skin of BIPV\* and translucent daylighting building panels - engages the "Hinomó' Cino"; People of the Plains Plaza & Sun Dance Pavilion which pays tribute and educates us all as to the area's earliest "sun-trackers", those indigenous people who once camped along this stretch of Boulder Creek.

\* Building Integrated Photo-voltaic

The Olmsted Lawn will be the core of the transformed Civic Center which will serve as an inclusive place for all to interact with each other and with our government and represent the cultural richness, history, and diversity of our community.

The "X"Ploratorium will anchor the corner of 13th and Arapahoe immediately south of the BMOCA expansion and the Year Round Farmer's Market. It will provide a high level of public benefit and showcase for residents and visitors alike Boulder's unique approach to its cultural heritage, the arts and science, and education. As an example, its roof top garden will provide collaborations between the adjacent Year Round Market and area students to demonstrate healthy eating/active living principles.



Under used largely due to its proximity to the traffic intensive Broadway and Canyon intersection, the re-purposed Glen Huntington Bandshell will anchor the POWWOW Amphitheater on the Olmsted Lawn. While maintaining its historic architectural character, the re-purposed facility will allow for a variety of community events and concerts.

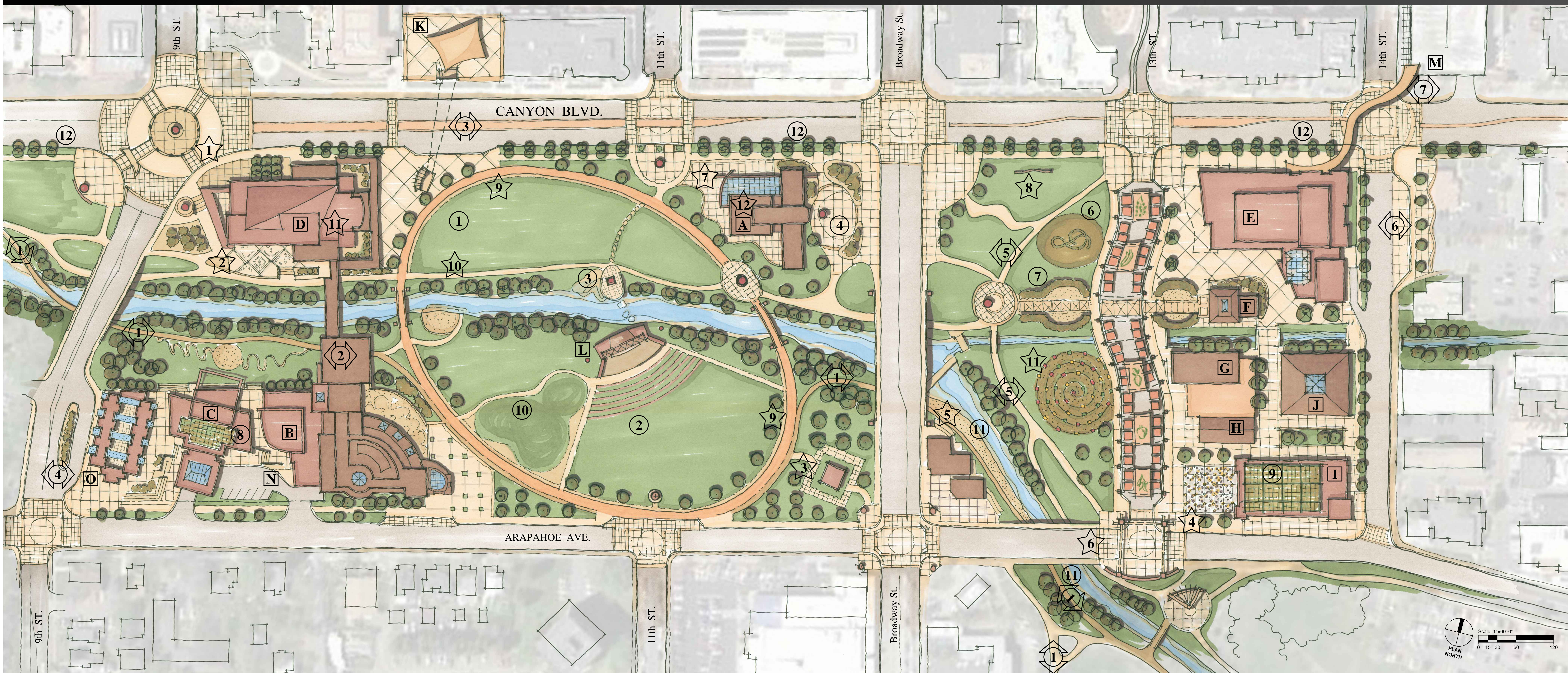

<b>FACILITIES</b>	<b>PARK, LAWN AND GARDENS</b>	<b>PLAZAS AND FEATURES</b>	<b>PATHS, TRAILS AND CONNECTIONS:</b>
<b>MUNICIPAL SERVICES:</b> A. Municipal Building B. Library Addition C. Senior Center D. E. Robert Turner Service Center	<b>CULTURAL:</b> E. Performing Arts Center F. Dishante Tea House G. BMOCA With Addition H. Year Round Market I. "X"ploratorium J. Community Room K. Civic Plaza L. Glen Huntington Bandshell	<b>PARKING:</b> M. 14th and Canyon N. 9th and Arapahoe	<b>OTHER:</b> O. Highlands Arapahoe Court
<b>PARK AND LAWN:</b> 1. Olmsted Lawn 2. POWWOW Amphitheater 3. Peace Garden Overlook 4. Ruth Wright Ellipse	5. Railroad Heritage Park 6. Josie Heath Rose Garden 7. Mary Axe Garden 8. Senior Center Rooftop Garden	9. X Ploratorium Roof Top Garden 10. Marilee Galapp Garden 11. Tuber's Beach 12. Water Street Promenade	<b>PLAZAS:</b> 1. Spoke of the Wheel Plaza 2. "Hinomó' Cino" - People of the Plains Plaza & Sun Dance Pavilion 3. Gilbert F White Plaza & Kiosk
<b>FEATURES:</b> 9. Frank Shorter soft trail track 10. Long Tom Pieser Exploration Trail 11. Dorothy Rupert Children's Feature 12. Municipal Beacons	4. X Ploratorium Plaza 5. Yocum's Overlook 6. Farmer's Market Auto Plaza 7. Mary Roberts Plaza 8. Railroad Heritage Walk	1. Multi-purpose path 2. Bus then Ride Station 3. Civic Plaza grade separated crossing 4. Highlands Bus Plaza	5. 13th St. Bike Lane 6. RTD Plaza and Bike then Ride Station 7. Civic Art Crossing & People Mover

NOTE: All intersections will incorporate vertical monuments, sensory and/or audible art installations.



1

# Overview

# CIVIC ART

**CIVIC ART** re-envision the transformative work created during Frederick Law Olmsted's infatuation with Boulder. Through his extensive appraisals, the many epoch periods and transects that have shaped our city were formalized and an appreciation towards "place-making" was indelibly burned into our community's spirit. **CIVIC ART's** proposals bolster our **Civic Heart** and ensure that it remains a "place for everyone — a lively and distinct destination that reflects our community's values, where people of all ages, abilities and backgrounds feel welcome to recreate, socialize, deliberate, learn and access city services" and the arts. Building upon our community's well established traditions for investment in sustainable and forward thinking solutions, the **CIVIC ART** team has conjured up the memories of past masters asking, "If alive today and fully conversant in the issues of our times, how would Olmsted and Burnham approach this opportunity" to again transform our community?"

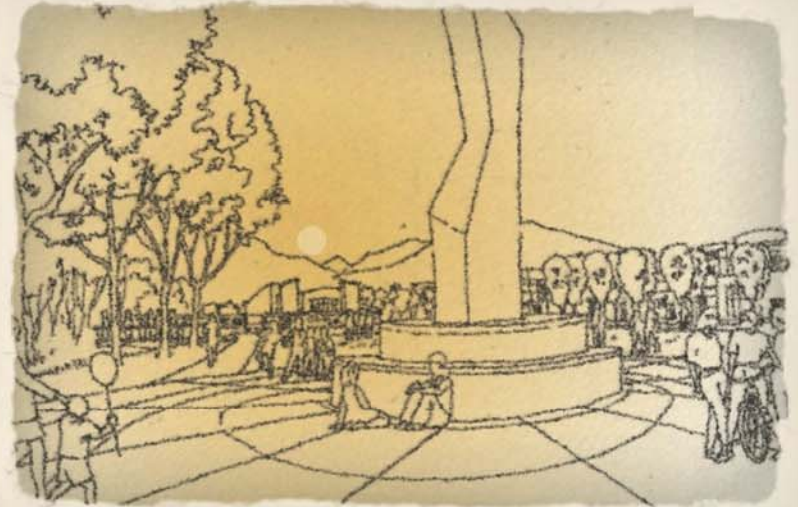

Location: \_\_\_\_\_

Submission No: \_\_\_\_\_ (Organizer Use Only)





2

# Approach

# CIVIC ART

**CIVIC ART** incorporates urban design **ideals** from Burnham's and Olmsted's 1892 World's Fair but with updated transformative actions responsive to current issues and our community's unique values that showcase Boulder's "Exceptionalism." While the 1892 Fair rejected innovative architecture, **CIVIC ART** provides a model of design excellence with compelling architecture and design reflecting "forward thinking." **CIVIC ART** understands that this new opportunity must present "Ideas Worth Spreading", not just from voices of the past but inclusive of all populations including those representing the future, our youth. **CIVIC ART** balances community services (western edge) with the arts (eastern edge) placed upon a common civic fabric of urban green. **CIVIC ART** further insists that the Civic Center be inclusionary and safe to all including the tenet that Knowledge be accessible to all. For this reason, light as a beacon is a constant theme, symbolic of "Art as Knowledge"



Civic Art's illuminated Municipal beacons will unify governmental buildings.



"The Pool" (credit Jenn Lewin Studio) provides an example for evening children's feature.

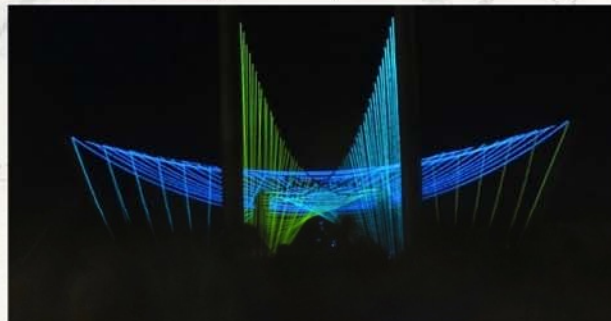

"Luminous Passage" (credit Hadrian Predock & John Frane) provides an example for creek path art below Broadway bridge.

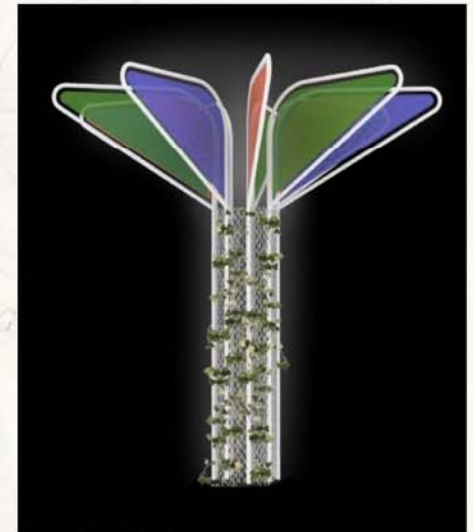

Civic Art's Monument concept @ night



Location: \_\_\_\_\_

Submission No: \_\_\_\_\_ (Organizer Use Only)





## 3

## Why Choose Our Design?

## CIVIC ART

**CIVIC ART** provides transformative “place-making” proposals that ensure viable and sustainable uses exemplifying our community’s economic, social and environmental values. The **CIVIC ART** proposals are built upon the team’s proven successes in building partnerships involving municipal, private and non-profit entities. Each is financially sound, providing direct community benefits, incorporating the latest renewable energy techniques, and outreach to all communities.



*Redevelopment of 9th and Arapahoe serves as an example of the mix of use and “place making” principles and strategies CIVIC ART proposes and includes:*

- Library Addition;
- New Senior Center (with roof top garden) and;
- The Highlands Arapahoe Court (image above) allowing expansion of its important Independent Living Program conveniently located to employment opportunities, public transportation and transitioning the Civic Center with the adjacent Highland neighborhood

*all sitting upon a flood protected parking structure that services city staff, visitors, and building users and provides connections for all modes.*



*Olmsted Lawn is shaped by a reconfigured multi-use path that provides north and south options and reduces conflicts. As a part of this new system, a “Bus then Bike” station will be located under the existing Library (image above). Well lit and actively used for storage and limited repairs by commuters and recreational riders, the new facility will also provide an enhanced sense of safety.*



## 4

## The Civic Heart of Boulder (Principle 1)

## CIVIC ART

**CIVIC ART** transforms the existing Civic Area into Boulder's "Civic Heart" symbolically, geographically, and functionally. **CIVIC ART** aggregates all core city management and government services in the new service center building. **CIVIC ART** showcases the cultural richness, history, and diversity of our community and proposes new centers for art and exploration. **CIVIC ART** allows for phasing but with established design principles that will result in the largest thematically cohesive, unified public outdoor space in Central Boulder and serve as models for design excellence. **CIVIC ART** provides compelling architecture and design reflecting forward thinking that create integrated places blending "natural" and "built" environments designed to be welcoming, accessible, comfortable, clean and safe. Most importantly, **CIVIC ART** fosters programming and design of spaces and facilities that encourage use and participation by all age groups, income levels, and visitors while complementing and providing linkages at multiple levels with surrounding neighborhoods and destinations.





5

## Life and Property Safety (Principle 2)

# CIVIC ART

Through the adaptive reuse and expansion of the original Library, the E. Robert Turner Service Center will allow removal of the Park Central and New Britain buildings from the High Hazard Zone and centralize all core departments. All proposed new facilities (the Service Center, the 9th & Arapahoe Redevelopment, the Performing Arts Center, the "X"Ploratorium, Community Room, Year Round Market, BMoCA Addition), public assembly spaces, urban features, emergency services, and critical government operations) will be in compliance with the potential Critical Facilities ordinance, if adopted.



*Existing surface parking will be relocated to flood protected parking structures and replaced by lawn and civic plazas. To the left is the Olmsted Lawn (with Frank Shorter running trail) and to the right, the northern edge of the Water Street Promenade.*



## 6

## Outdoor Culture &amp; Nature (Principle 3)

## CIVIC ART

**CIVIC ART** bolsters the Boulder Creek linear park as a unifying focus for natural beauty, ecological function, flood safety, recreational, art, and cultural opportunities. Removal of the New Britain and Park Central buildings as well as all surface parking lots enhance life and property safety and allow incorporation of the expansive Olmsted Lawn. Exploration will happen at all levels. As an example, the Long Tom trail is for children-of-all-ages running parallel to Boulder Creek and celebrating Boulder's historic mining roots. Other children's exploration areas are found throughout the connected green space of the Civic Area. Public Art displays ranging from Native Americans tributes to acknowledging today's scientific community will dot the green spaces and plazas and reflect the unique essence of Boulder. With new construction limited to the east and west ends of the Civic Area, spectacular views of the mountains and the rest of Boulder will be plentiful. New, improved and artistic lighting displays increase safety and invite the community to enjoy the Civic Area in the evenings too, strolling along paths or sitting at strategically placed benches.



*"Hinono' Cino"; People of the Plains Plaza & Sun Dance Pavilion*



*Gilbert F. White Kiosk*



7

## Celebration of History & Existing Assets (Principle 4)

# CIVIC ART

**CIVIC ART** expands upon our evocative heritage and is a “Celebration of History” preserving, reflecting and celebrating the area’s fully inclusive history and embodies the legacies burned into our cultural memory by indigenous populations, mining and railroad enterprises. **CIVIC ART** builds upon the City’s tradition of making this the “Civic Heart of the Boulder” including the Farmer’s Market, the Sister City Plaza/Dushanbe Teahouse, Central Park and Bandshell. Reconfiguration of Central Park, which retains Olmsted’s original concepts for a linear creek but responsive to the functional challenges of the 21st Century, provides needed enhancements to the existing and proposed facilities. A widened 13<sup>th</sup> Street relieves the cramped gridlock of peak use periods providing more enjoyable user experiences. Underground structured parking (flood protected) provides easy, convenient access for all and reducing impacts to adjacent neighborhoods. A Year Round Farmers Market encourages sharing of information about local food and farms while expanding access to local vendors. Relocation of The Glen Huntington Bandshell to the POWWOW Amphitheater enhances its functionality while maintaining its architectural significance. The repurposed facility provides a state of the art outdoor venue accommodating up to 4,000 providing significant economic benefit to the downtown area.





## CIVIC ART

**CIVIC ART** enhances all bicycle and pedestrian amenities and convenient transit connections while bolstering the area as an important destination and connector. Travel and access to the area will continue to be improved. Features, such as the “Bike then Bus” facilities enhances the pedestrian, bicycle and commuter experience. Improved connections and way-finding between the Civic Center, downtown, university and adjacent neighborhoods for users and visitor arriving by auto, foot, bike or transit have been provided. Two new protected parking structures provide adequate, not maximum, parking. Connections between existing parking facilities in the downtown area are intended to improve shared use especially during peak periods. Intersection improvements and incorporating visual, sensory and audible public art features, along with the “Water Street Promenade” will reduce the existing barrier-effect of major thoroughfares. All public streets and event areas consider multiple use.



*Civic Center Crossing and People Mover incorporates features of this piano key escalator in China connecting people between the existing 14th & Walnut Parking and the Performing Arts Center.*



Submission No: \_\_\_\_\_ (Organizer Use Only)



*“Bus then Bike” facility*



*The 1992 Civic Center Master Plan established the tradition of “auto-courts”. Civic Art proposes expansion, relocation of the bike path and incorporating proposed overhead shade devices and lighting from that plan.*





## CIVIC ART

The eastern portion of the Civic Center will be anchored by a new “Crown Jewel”; a performing arts complex. It will augment existing cultural facilities like the Farmers’ Market, BMoCA, and the Dushanbe Tea House. This center will reflect and enhance the unique essence and brand of Boulder. A state-of-the-art performance venue seating 1000 would be the heart of this new home for the creative community of Boulder. Developed with a public-private partnership with a nonprofit, it would provide a much needed venue for local arts and entertainment organizations and generate enormous economic impact. The center can be operated sustainably without ongoing direct City support. Combined with open spaces, plazas, water features along the ditch, cafés and retail, the civic area could be a home to the entire creative spirit of Boulder, including local farmers, natural food entrepreneurs, artists and performers, and the creative minds working in the tech industry. This performing arts complex will be the perfect complement to the Pearl Street Mall and Boulder’s fantastic outdoor recreational opportunities.



13th St. Entrance to Performing Arts Center



Interior of Year Round Market



Boulder “X”Ploratorium